

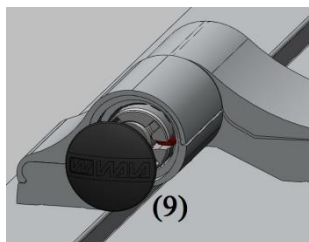

Hinge adjustment:

Adjustment of gasket clamping force:

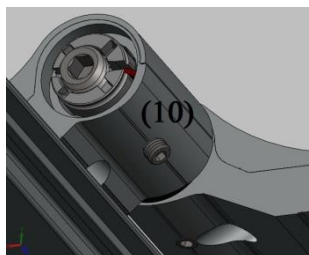

Remove the plug (9), (e.g. by prying with a flat screwdriver).



Open the door and loosen the M6x5 set screw  (10).

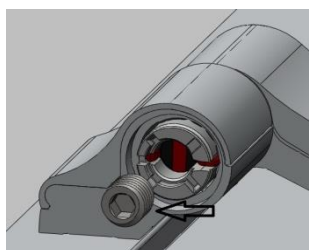

Remove the M12 set screw.

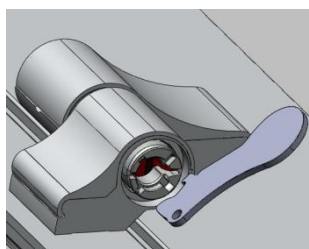

Insert:

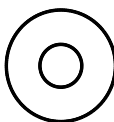
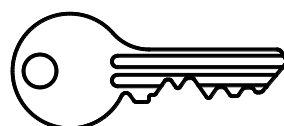



KEY
WASHER
OR
FLAT DISC $\phi 30$

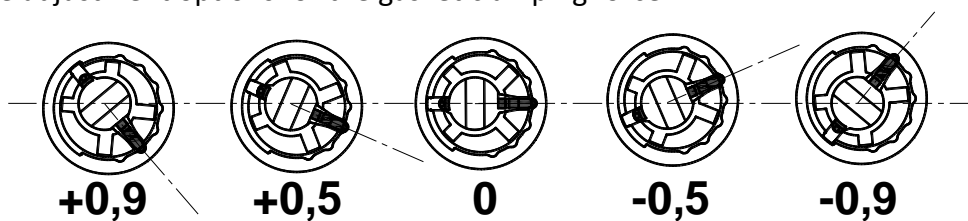

Flat screwdriver, 15 mm wide

Available adjustment options for the gasket clamping force:



- drive in the M12 set screw [until a slight drag is noticed],
- insert and tighten the M6x5 set screw  (10),
- install the plug (9).

VERTICAL adjustment:

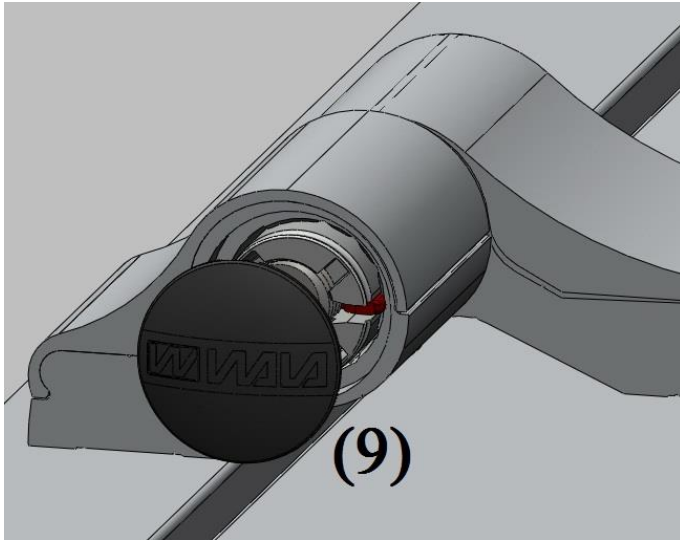

Remove the plug (9), (e.g. by prying with a flat screwdriver).

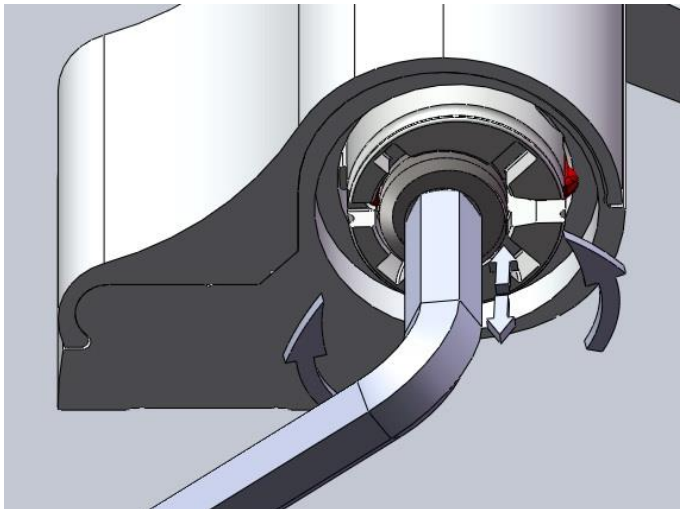

Tightening the M12 set screw adjusts the hinge vertically (+ 4mm).

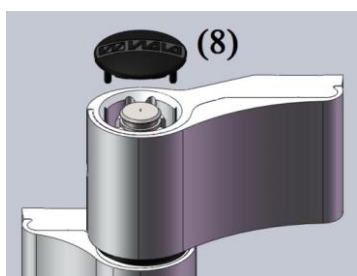

After the adjustment:

- insert and tighten the M6x5 set screw  (10),
- install the plug (9).

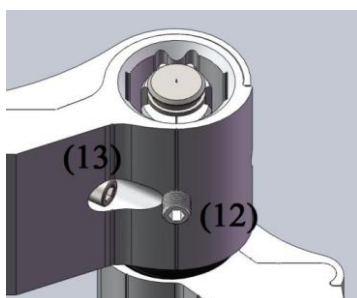

Remove the plug (8) (e.g. by prying with a flat screwdriver).



Open the door and loosen the M4 screw  (13) used for cover locking and loosen the M6x5 set screw  (12).

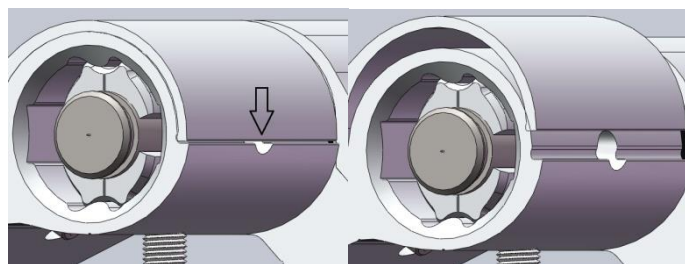

Using the process hole, pull up the cover with a flat screwdriver to access adjustment devices.

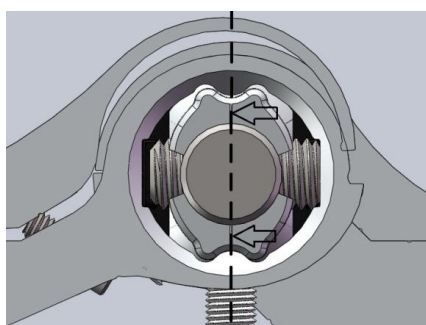

The hinge is kept in zero position when the markings are aligned (coinciding with a theoretical axis).

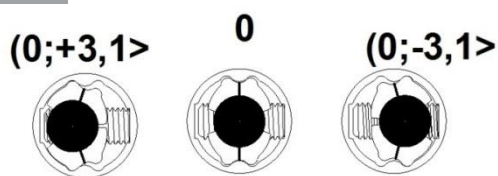

Adjustment range

After the adjustment:

- tighten the M6x5 set screw (12),
- replace the covers,
- tighten the M4 screw (13),
- replace the plug (8).